

5027# S35 搪銑主軸頭 Boring & Milling Head Unit

規格	Model	S35	S35H
主軸	Spindle	MT3 or ER32	
最高轉速	Max. RPM	3000	10000
軸承	Bearing	32007 / 6007Z 32006 / 6006Z	7007×2 7006×2
真圓度	Roundness	Within 0.003mm 內	
最大動力	Max. Power	Within 1 HP 內	
溫升	Rising Temperature	Within 20°C 內	

★出廠附精度檢驗表

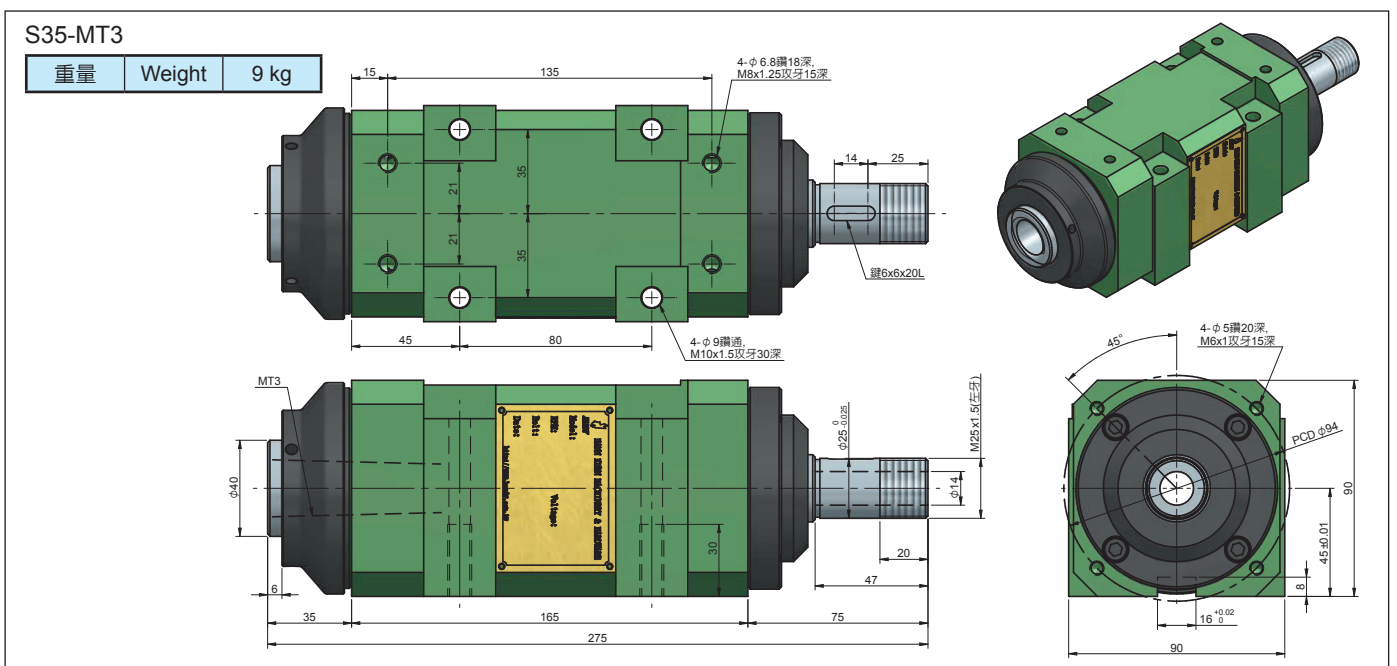
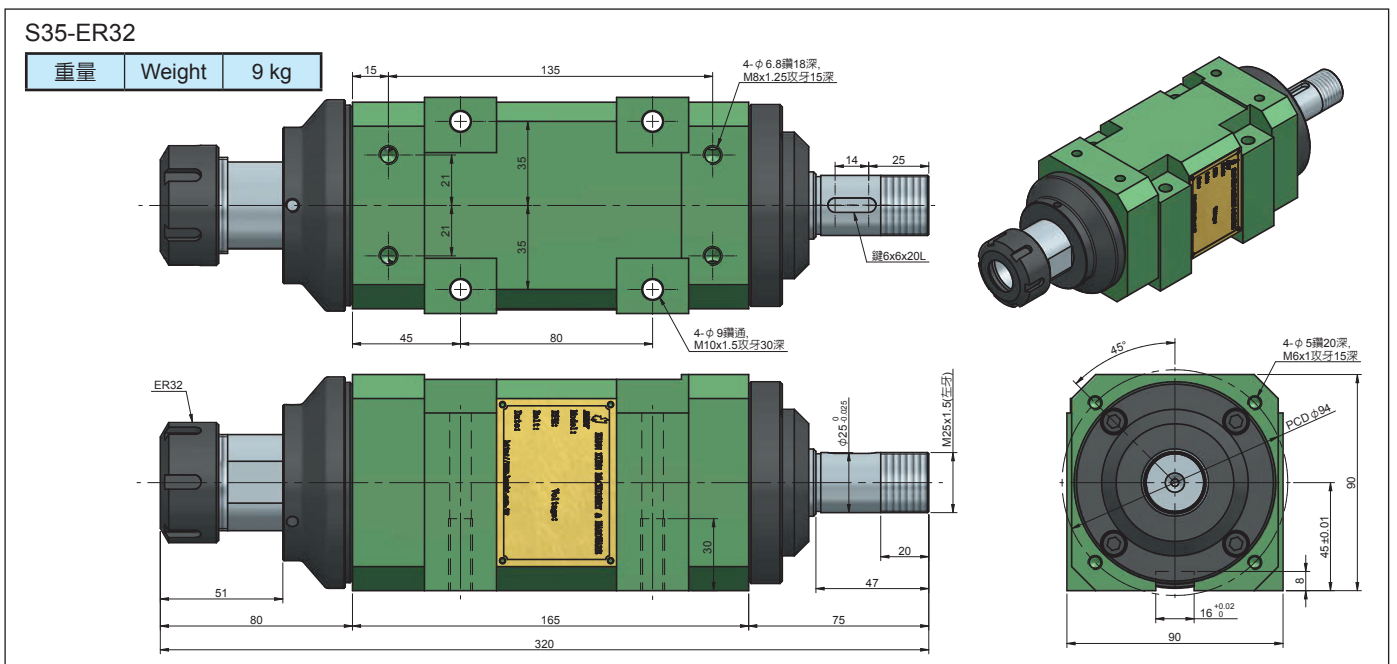

5027# S35 搪銑主軸頭 Boring & Milling Head Unit

S35-ER32-MF
S35-MT3-MF

重量	Weight	30 kg
----	--------	-------

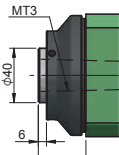
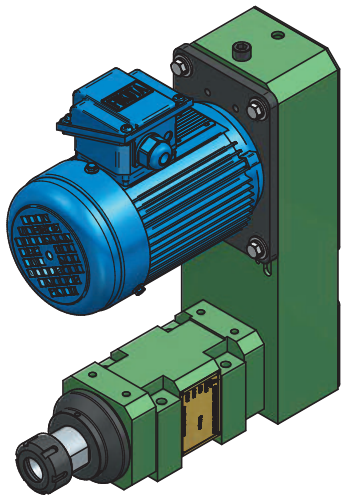

MT3

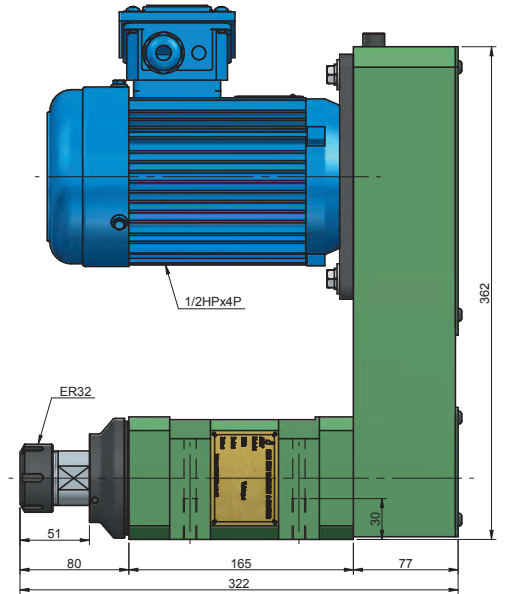
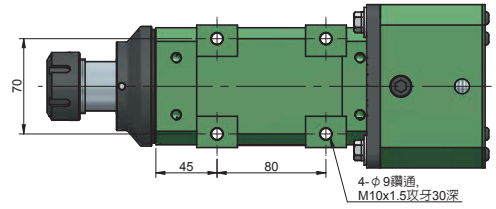
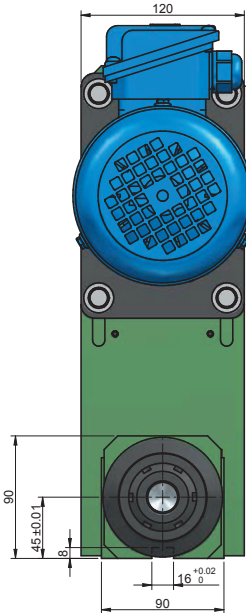

S35-ER32-MB
S35-MT3-MB

重量	Weight	30 kg
----	--------	-------

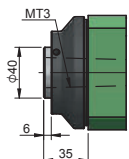
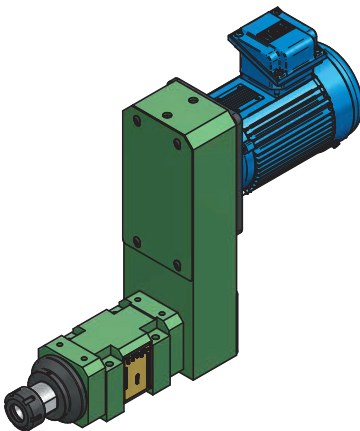

MT3

